

STRUCTURALLY CERTIFIED

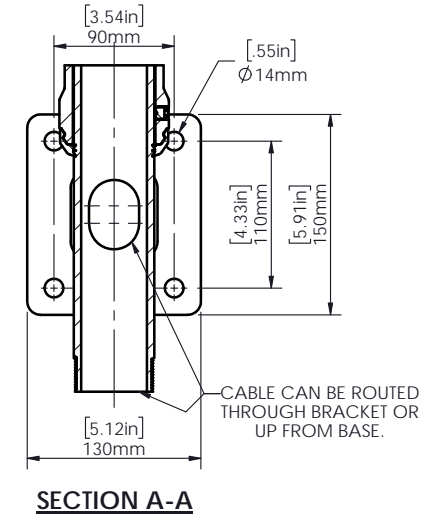
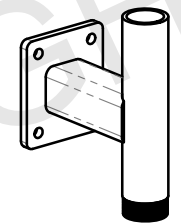
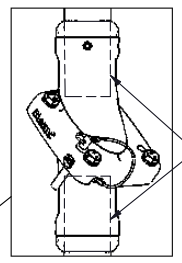
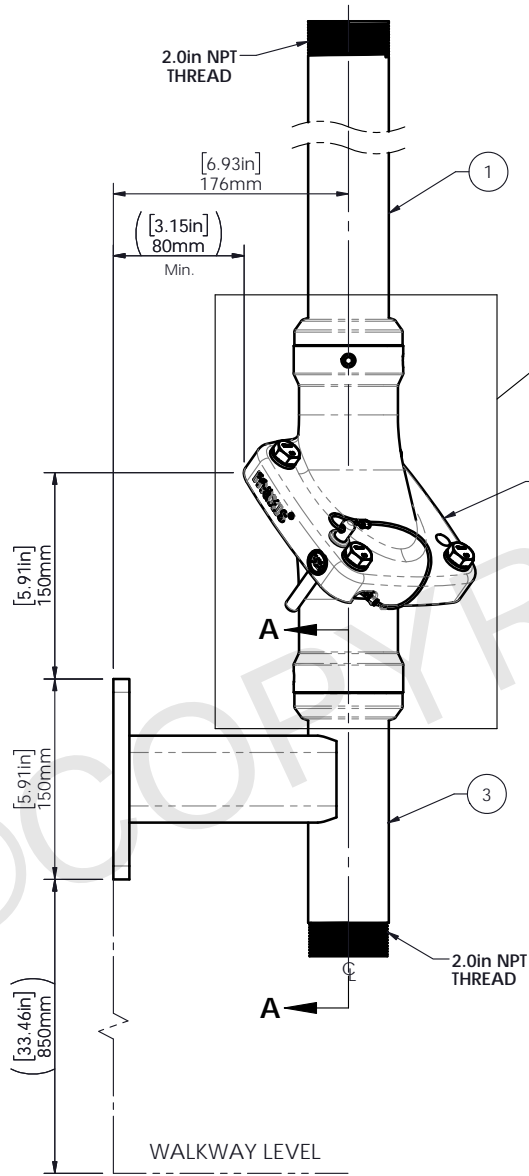
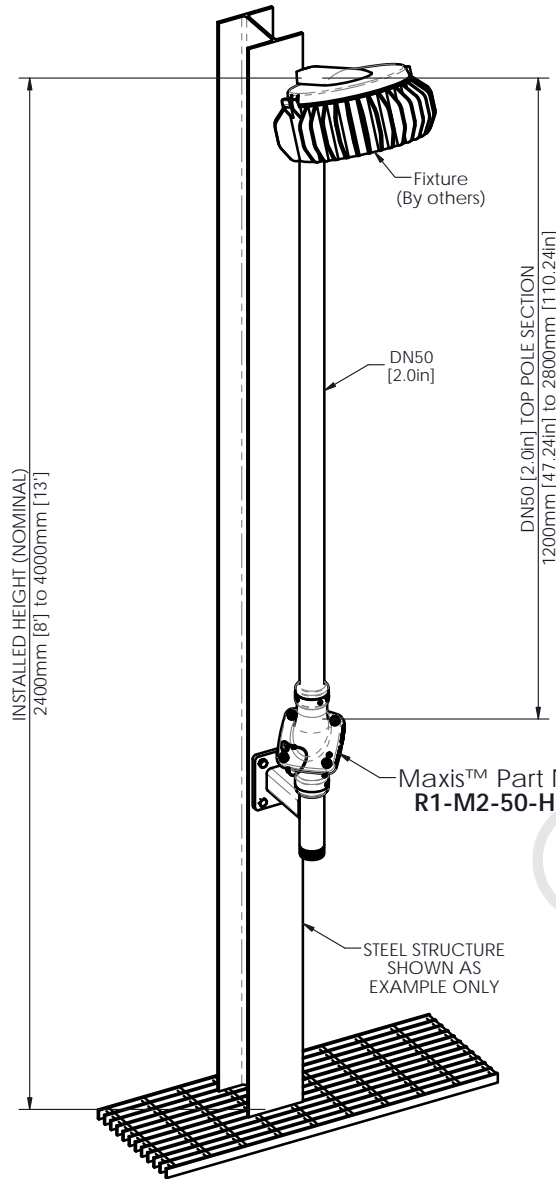

ITEM No.	QTY.	DESCRIPTION	MATERIAL OPTIONS
1	1	TOP POLE SECTION - PLAIN	STEEL / HOT-DIP GALVANIZED ALUMINUM
2	1	Maxis™ M2 JOINT	STEEL / HOT-DIP GALVANIZED
3	1	Swivelpole™ MB3-T-50-HG MOUNTING BRACKET	STEEL / HOT-DIP GALVANIZED

Ordering Information: ALUMINUM

INSTALLED HEIGHT	PRODUCT CODE	WEIGHT	MAX EQUIPMENT WEIGHT
2400mm [8']	C2-M2-2400-T-HG-AL	13.5 kg (29.7 lb)	20.0 kg (44.0 lb)
3000mm [10']	C2-M2-3000-T-HG-AL	14.8 kg (32.6 lb)	20.0 kg (44.0 lb)
4000mm [13']	C2-M2-4000-T-HG-AL	16.9 kg (37.2 lb)	15.0 kg (33.0 lb)

Ordering Information: HOT-DIP GALVANIZED

INSTALLED HEIGHT	PRODUCT CODE	WEIGHT	MAX EQUIPMENT WEIGHT
2400mm [8']	C2-M2-2400-T-HG	17.4 kg (38.3 lb)	20.0 kg (44.0 lb)
3000mm [10']	C2-M2-3000-T-HG	20.6 kg (45.3 lb)	20.0 kg (44.0 lb)
4000mm [13']	C2-M2-4000-T-HG	26.0 kg (57.2 lb)	15.0 kg (33.0 lb)

C2-M2 - COLUMN / WALL MOUNTED TYPICAL ASSEMBLY



Scan Code with QR Reader app for more Swivelpole™ Solutions

maxis
PATENTED PRODUCTS
www.maxisjoint.com

PATENTED PRODUCTS
www.swivelpole.com

Swivelpole

This document is the property of and protected by copyright owned by Swivelpole Group Pty Ltd and/or Exemplar Products Pty Ltd. The designs and other information embodied in this document comprise confidential information of Swivelpole Group Pty Ltd and/or Exemplar Products Pty Ltd and form part of products covered by international patents and registered designs including US patent No 6957832 and US patent No 9945143. Unauthorised use, reproduction and disclosure are strictly prohibited. This document must not be removed from the premises of the licensed user of this document without Swivelpole Group Pty Ltd's and/or Exemplar Products Pty Ltd's prior approval.

ALL DIMENSIONS ARE IN MILLIMETERS / INCHES	SERIES / CODE C	PART NUMBER As Noted	(RQ1851 - 3/3/23)
DRAWN BY BP	DATE 30/09/20	TITLE Swivelpole™ C2 - Maxis™ M2 MB3 Bracket, Top Pole Section - THREADED General Assembly	REV 2
CHECKED BY KM	DATE 30/09/20	DRG No C-NEC-C2-M2-5050-T-(HG-AL)	A3
APPROVED BY AI	DATE 30/09/20	SCALE N.T.S.	
THIRD ANGLE PROJECTION			

NEC

STRUCTURALLY CERTIFIED

ITEM No.	QTY.	DESCRIPTION	MATERIAL OPTIONS
1	1	TOP POLE SECTION - THREADED	316 STAINLESS STEEL
2	1	Maxis™ M2 JOINT	316 STAINLESS STEEL
3	1	Swivelpole™ MB3-T-50-SS MOUNTING BRACKET	316 STAINLESS STEEL

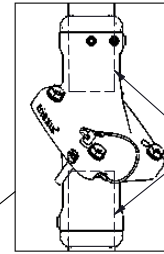
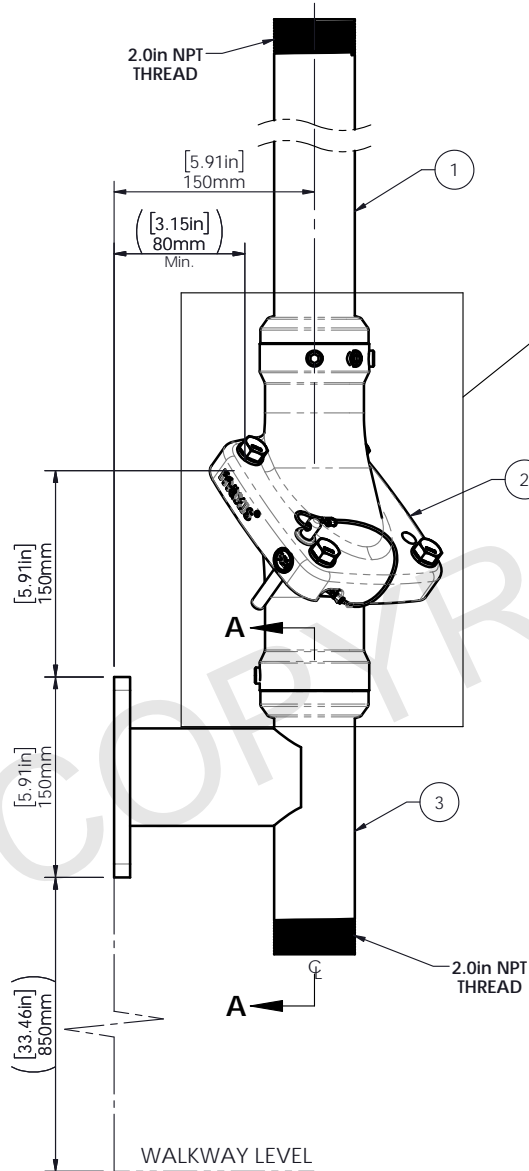
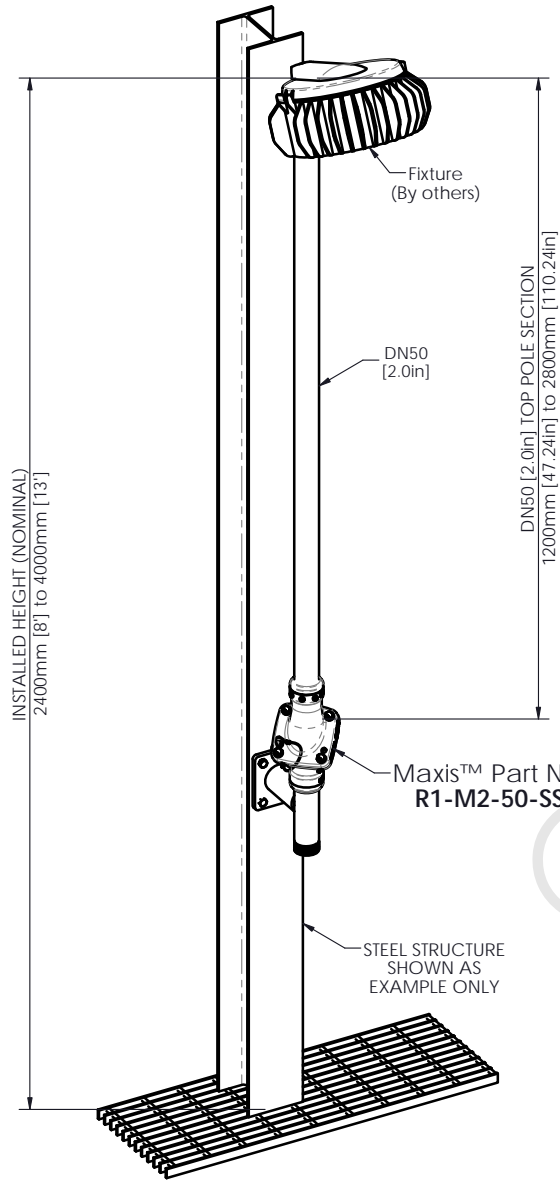

PIPE SECTIONS ARE INSERTED INTO Maxis™ JOINT

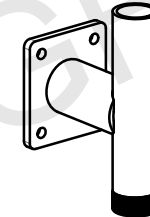

ITEM 3
**MB3-T-50-SS
BRACKET**

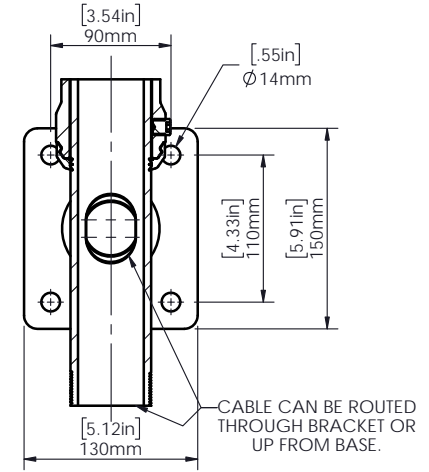

SECTION A-A

Ordering Information: 316 STAINLESS STEEL

INSTALLED HEIGHT	PRODUCT CODE	WEIGHT	MAX EQUIPMENT WEIGHT
2400mm [8']	C2-M2-2400-T-SS	18.4 kg (40.5 lb)	20.0 kg (44.0 lb)
3000mm [10']	C2-M2-3000-T-SS	21.7 kg (47.7 lb)	20.0 kg (44.0 lb)
4000mm [13']	C2-M2-4000-T-SS	27.3 kg (60.1 lb)	15.0 kg (33.0 lb)

C2-M2 - COLUMN / WALL MOUNTED
TYPICAL ASSEMBLY



Scan Code with QR Reader app for more Swivelpole™ Solutions

maxis
PATENTED
PRODUCTS

www.maxisjoint.com

PATENTED
PRODUCTS

www.swivelpole.com

Swivelpole

This document is the property of and protected by copyright owned by Swivelpole Group Pty Ltd and/or Exemplar Products Pty Ltd. The designs and other information embodied in this document comprise confidential information of Swivelpole Group Pty Ltd and/or Exemplar Products Pty Ltd and form part of products covered by international patents and registered designs including US patent No 6957832 and US patent No 9945143. Unauthorised use, reproduction and disclosure are strictly prohibited. This document must not be removed from the premises of the licensed user of this document without Swivelpole Group Pty Ltd's and/or Exemplar Products Pty Ltd's prior approval.

ALL DIMENSIONS ARE IN MILLIMETERS / INCHES		SERIES / CODE	PART NUMBER
		C	As Noted (RQ1852 - 3/3/23)
DRAWN BY	DATE	TITLE	
KM	07/02/23	Swivelpole™ C2 - Maxis™ M2	
CHECKED BY	DATE	MB3 Bracket, Top Pole Section - THREADED	
BP	07/02/23	General Assembly	
APPROVED BY	DATE	DRG No	
AI	07/02/23	C-NEC-C2-M2-5050-T-SS	
THIRD ANGLE PROJECTION	SCALE	N.T.S.	REV 1 A3

NEC